



# RICAMBI / SPARE PARTS



# ISTRUZIONI DI INSTALLAZIONE / INSTALLATION INSTRUCTION

ART. 7811/1A

COD. 885041

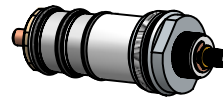

COD. 755050

COD. 752011

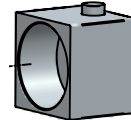
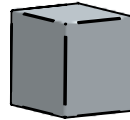

COD. 755053

COD. 785013

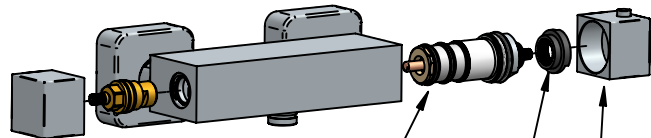

COD. 755050

COD. 885041

COD. 752011

COD. 785013

COD. 755053

ART. 7811/1A

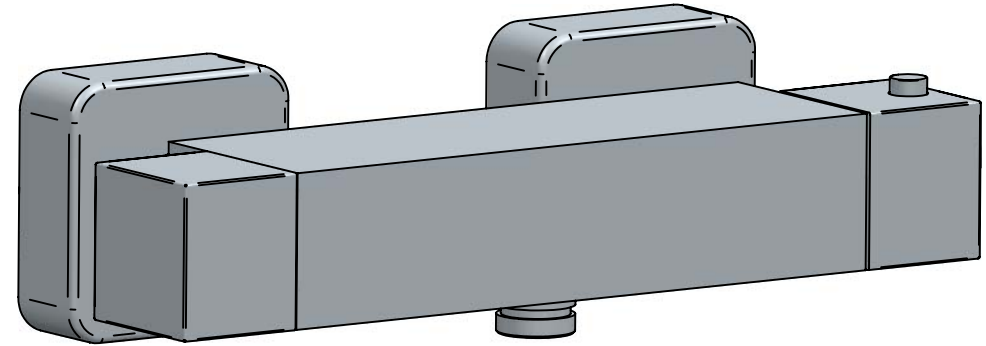

1



2

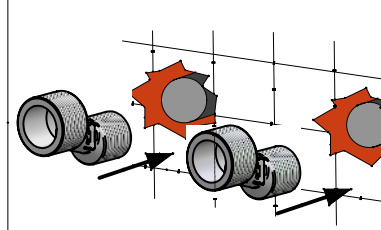

3

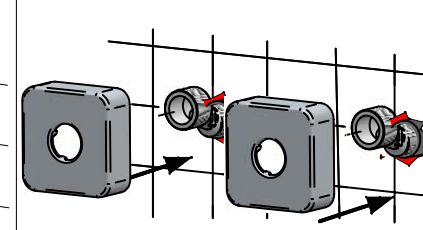

4

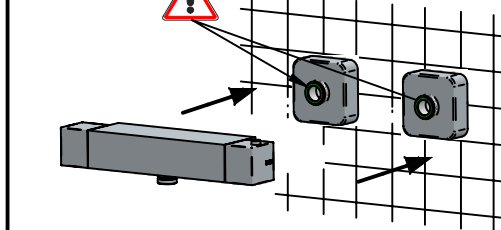

5



2

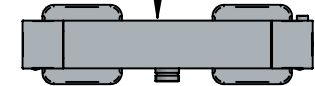

1

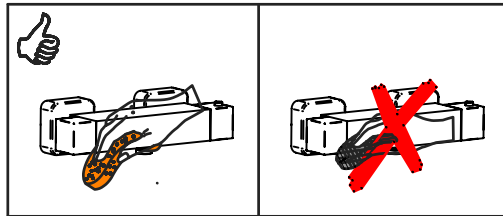
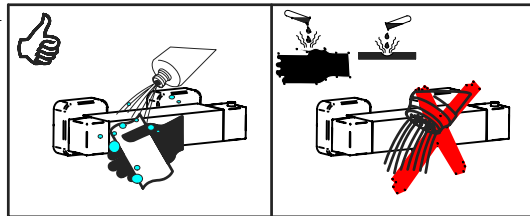
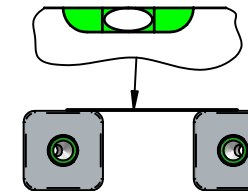

## MANUTENZIONE E PULIZIA

Per una corretta manutenzione e pulizia di questo prodotto, raccomandiamo alcuni semplici accorgimenti:

- Utilizzare **detergenti neutri**, spruzzando il prodotto direttamente su un panno morbido onde evitare infiltrazioni
- Evitare **sempre** il contatto con prodotti acidi o abrasivi
- **Risciacquare bene** con abbondante acqua per eliminare eventuali residui ed **asciugare sempre** con un panno morbido
- Effettuare una **pulizia periodica** al fine di prevenire le formazioni calcaree

La BELLOSTA CARLO & C. non è RESPONSABILE di danni derivati dall'utilizzo di prodotti impropri per la pulizia.

## MAINTENANCE AND CLEANING

For a proper maintenance and cleaning, we recommend the following:

- Use **neutral detergents**, avoiding to spray directly on taps to avoid residual infiltration
- **Avoid** contact with acid or abrasive products
- **Rinse** with water and **always dry** with a clean cloth to avoid residue of detergent
- Perform a **periodic cleaning** to prevent limestone deposits

BELLOSTA CARLO & C. cannot be held responsible for damages due to an improper use of detergents



> ufficio tecnico BELLOSTA - B.I. 06/06 ISO 9001-2000 SCQ

D

MADE IN ITALY

DESIGN

EQB

MADE IN ITALY

This product has been entirely manufactured in Italy, by top quality raw materials.

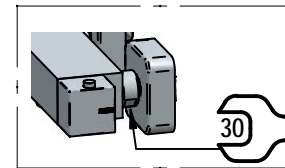

A

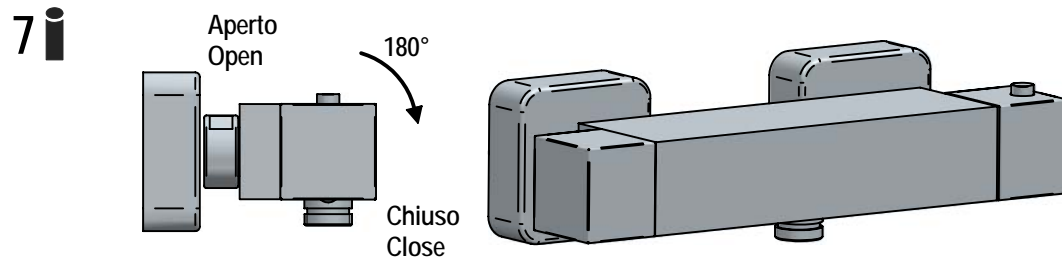
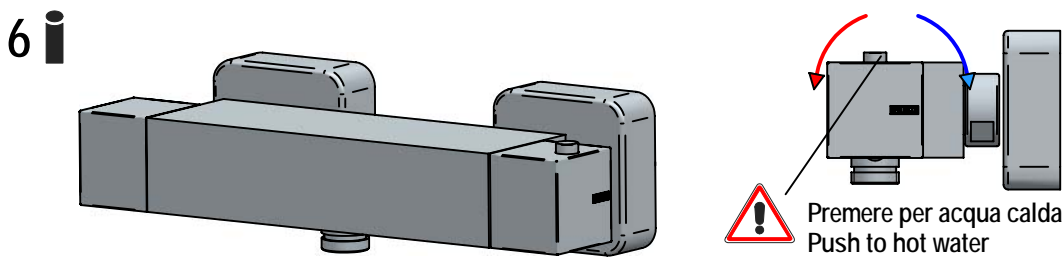

### SOSTITUZIONE VITONE / LEFT CERAMIC VALVE REPLACEMENT

Prima di iniziare le operazioni di sostituzione del vitone assicurarsi che l'acqua dell'impianto principale sia chiusa e che il vitone sia svuotato da residui di acqua.

Before starting replacement of left ceramic valve, ensure that water system has been turned off and empty remaining water.

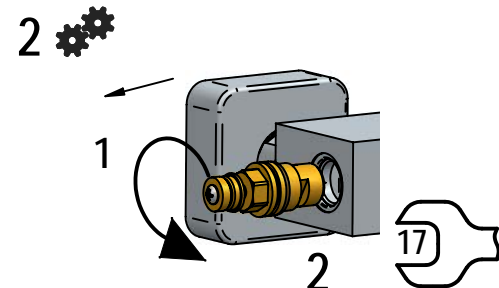
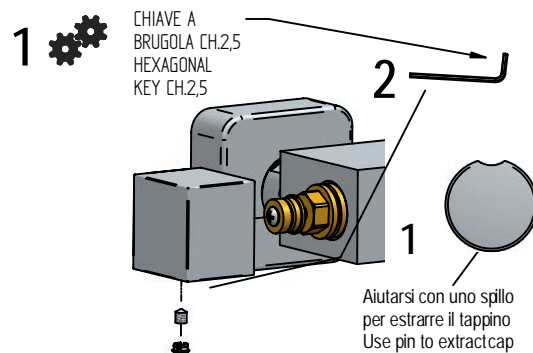

### DATI TECNICI / TECHNICAL DATA

- Pressione massima di esercizio :  
5 bar
- Pressione minima senza resistenza :  
0,5 bar
- Pressione raccomandata :  
2 - 4 bar ( 3 bar Ottimale )

- Maximum operating pressure :  
5 bar
- Minimum pressure without resistance :  
0,5 bar
- Recommended pressure :  
2 - 4 bar ( 3 bar Ottimale )

### DATI TECNICI / TECHNICAL DATA

- Blocco sicurezza 38°C :  
tarato in fabbrica con pressione 3 bar (calda e fredda)
- Per pressioni superiori 5 bar :  
si raccomanda riduttore di pressione
- Presenza acqua molto dura :  
si raccomanda uso di un filtro addolcitore
- Forti differenze di pressione :  
oltre 4 bar tra calda e fredda regolare la temperatura dell'acqua ruotando l'asta cartuccia in senso antiorario (calda) e in senso orario (fredda)

- Safety block 38°C :  
calibrated in the factory at a pressure of 3 bar (hot and cold)
- For pressure over 5 bar :  
the pressure reducer is recommended
- For very hard water :  
the lime filter is recommended
- Strong pressure differences :  
over 4 bar between hot and cold water the temperature of the mixer water can be adjusted by turning the broached pin, anti-clockwise (hot) and clockwise (cold)

### PULIZIA CARTUCCIA SOSTITUZIONE CARTUCCIA

Prima di iniziare le operazioni di sostituzione della cartuccia assicurarsi che l'acqua dell'impianto principale sia chiusa e che la cartuccia sia svuotata da residui di acqua.

### THERMOSTAIC VALVE CLEANING AND REPLACEMENT

Before starting replacement of cartridge, ensure that water system has been turned off and empty remaining water.

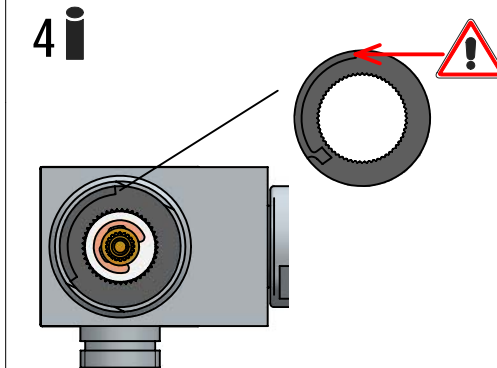
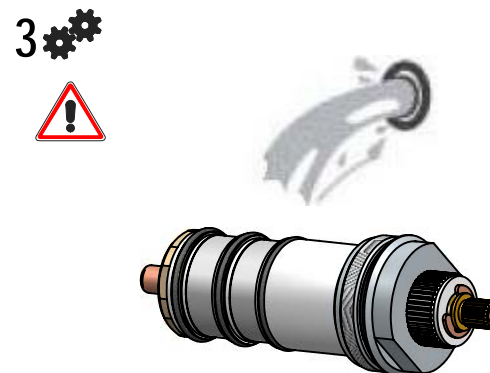
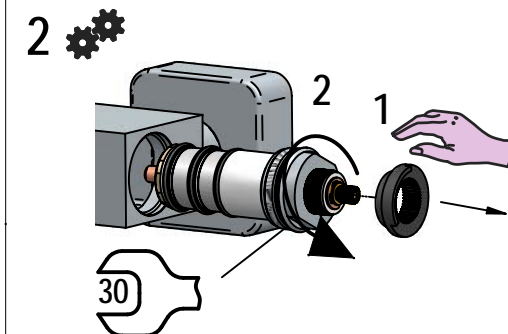
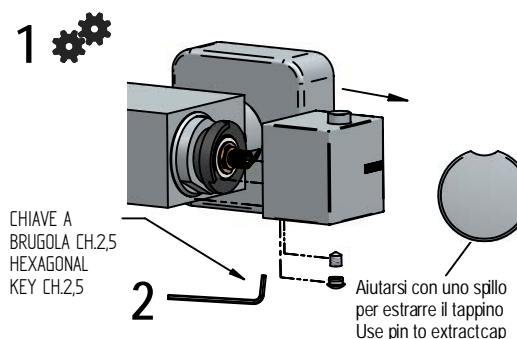

Per qualsiasi richiesta di informazioni, preghiamo contattare l'Ufficio Tecnico presso:  
info@bellostarubinetterie.com

B For any technical inquiries, please contact the Technical Office at: info@bellostarubinetterie.com